

**FEATURES :**

- **Small Size**
- **High Power**
- **Low loss**

**SPECIFICATIONS**

Center Frequency, [GHz]	34.5
Passband Frequency, [GHz] min.	32.6 to 36.36
Passband Loss, [dB] max.	2.0

Reject Bands, [GHz]	DC to 28 & 40 to 50
Reject Attenuation, [dB] min.	50
VSWR	1.5 : 1
Average Power, [Watts]	5

**Operating Characteristics**

Operating Temperature	-40°C to +85°C
Impedance, [Ohm]	50

**Ordering Information**

<b>Model No.</b>	<b>Connectors</b>
FCL6-34500-4000	2.92mm-female

**Outline drawing**

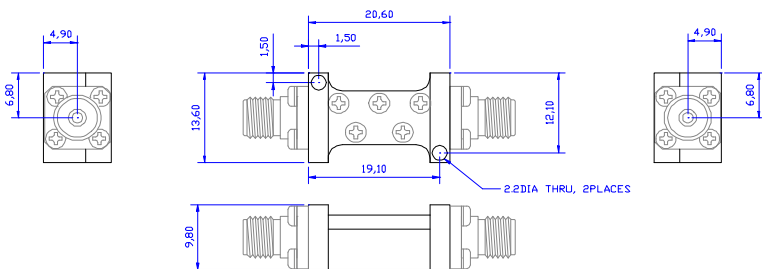

Dimensions in mm

**Typical Performance**

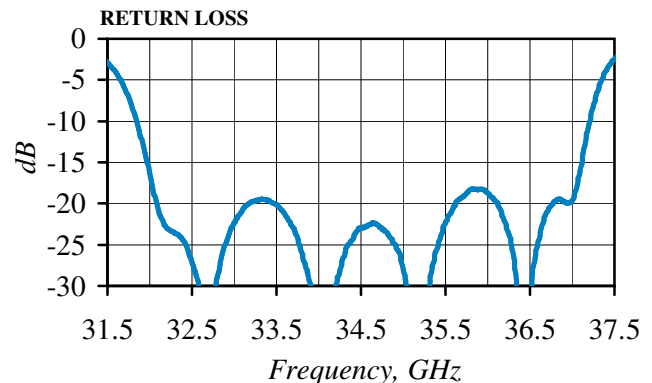
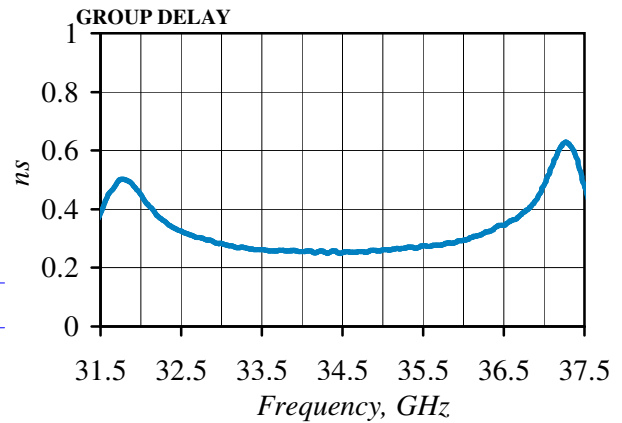
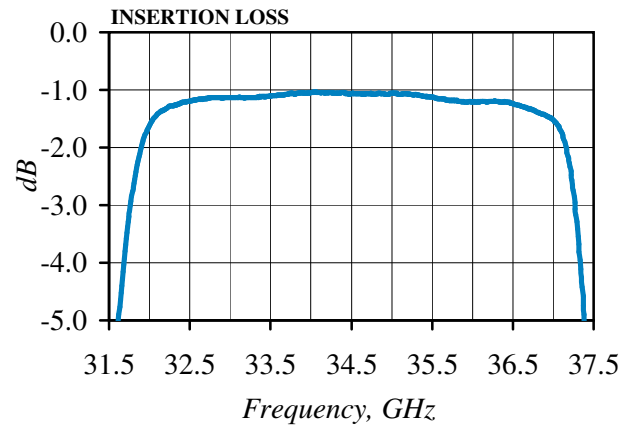
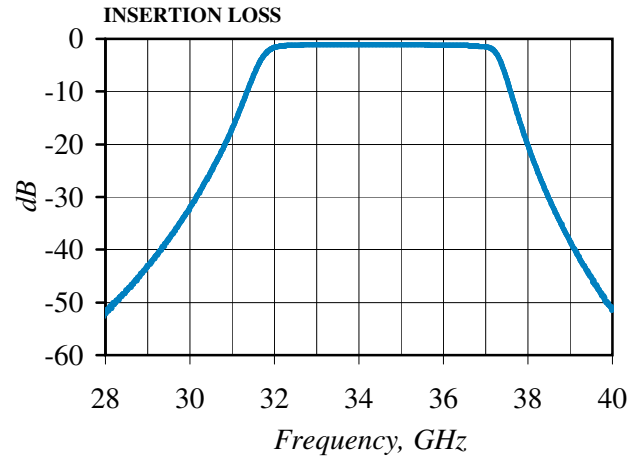

Specifications Subject To Change Without Notice

Rev. B 06.03.2023

