

**FEATURES :**

- Notch Frequency 394.5MHz
- 60dB Rejection
- Passband up to 2.9GHz

**SPECIFICATIONS**

Stopband Frequency, [MHz]	394 to 395
Stopband attenuation, [dB] min.	60
Lower Passband Frequency, [MHz]	DC to 380
Higher Passband Frequency, [MHz]	420 to 2900
Passband Loss, [dB] max.	1.5
VSWR @ DC-380 MHz & 420-2000 MHz	2.0:1
VSWR @ 2000-2900MHz	2.5:1

**Operating Characteristics**

Input Power, CW [W] with matched load	10
Impedance, [Ohm]	50
Operating Temperature, [°C]	-20 to +70

**Ordering Information**

Model No.	Connectors
FSL3-393-1-SMA	SMA

**Outline drawing** dimensions in mm

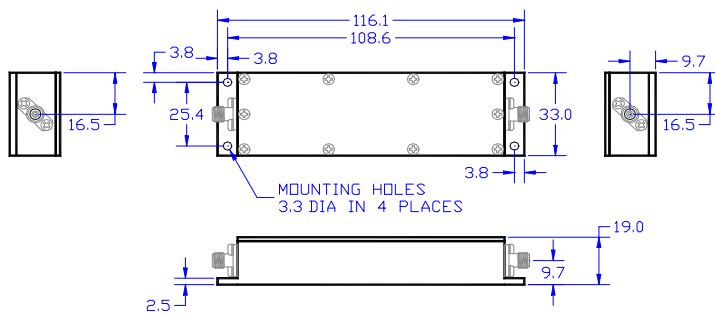

**Typical Performance**

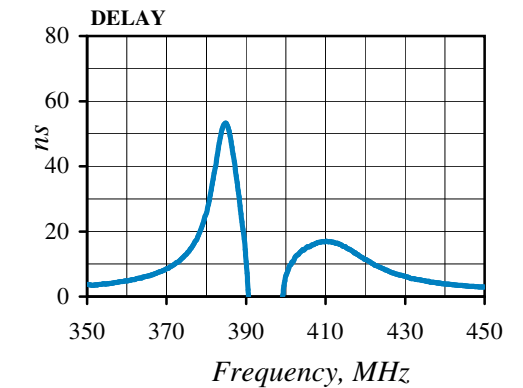
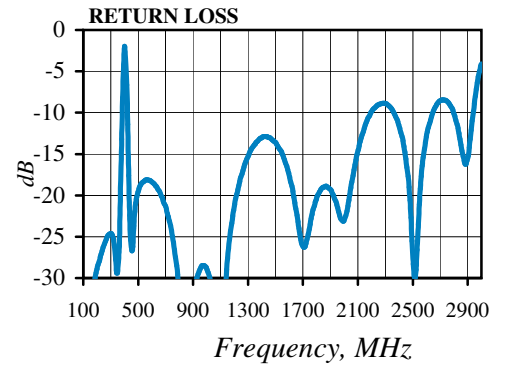
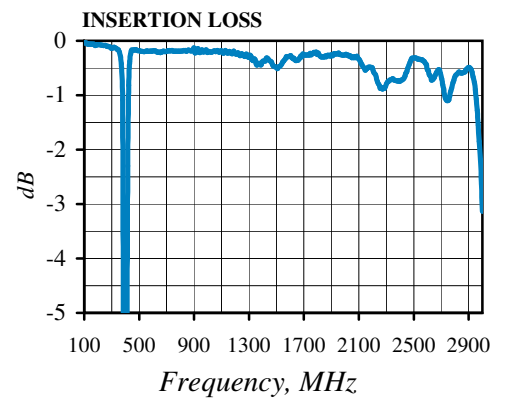
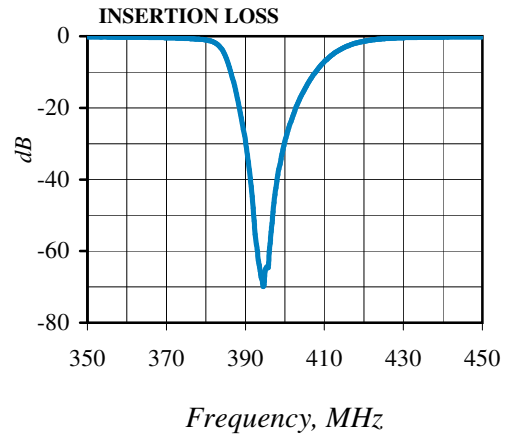

Specifications Subject To Change Without Notice  
Rev. A 12.01.2023

