

**FEATURES :**

- **High Power**
- **Low Loss**

**SPECIFICATIONS**

Center Frequency, [MHz]	10.35
Insertion Loss@CF [dB] max.	1.2
1dB Bandwidth, [MHz] min.	1.1
20dB Bandwidth, [MHz] max.	2.0
Reject Bands, [MHz]	DC to 8.1 and 12.9 to 250
Reject Attenuation, [dB] min.	60
VSWR	1.5 : 1
Average Power, [Watts]	100
<b>Operating Characteristics</b>	
Operating Temperature	-40°C to +85°C
Impedance, [Ohm]	50

**Ordering Information**

Model No.	Connectors
FBL5-10.35-0.7	N

**Outline drawing**

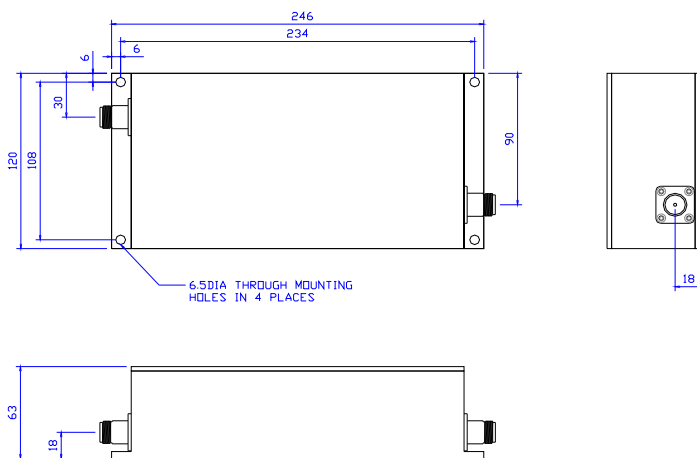

Dimensions in mm

