

FEATURES :

- *Low Loss*
- *High Power 500W CW*
- *Elliptic Design*

SPECIFICATIONS

3dB Corner Frequency, [MHz] min.	26
Passband Loss DC to 25MHz, [dB] max.	0.5
Rejection 30MHz to 150MHz, [dB] min.	30
VSWR	1.5 : 1

Operating Characteristics

Input Power, [W] with matched load	150
Impedance, [Ohm]	50
Connectors	N female
Operating Temperature	-20°C to +70°C

Ordering Information

Model No.
FLLE-25-500W

Outline drawing dimensions in mm

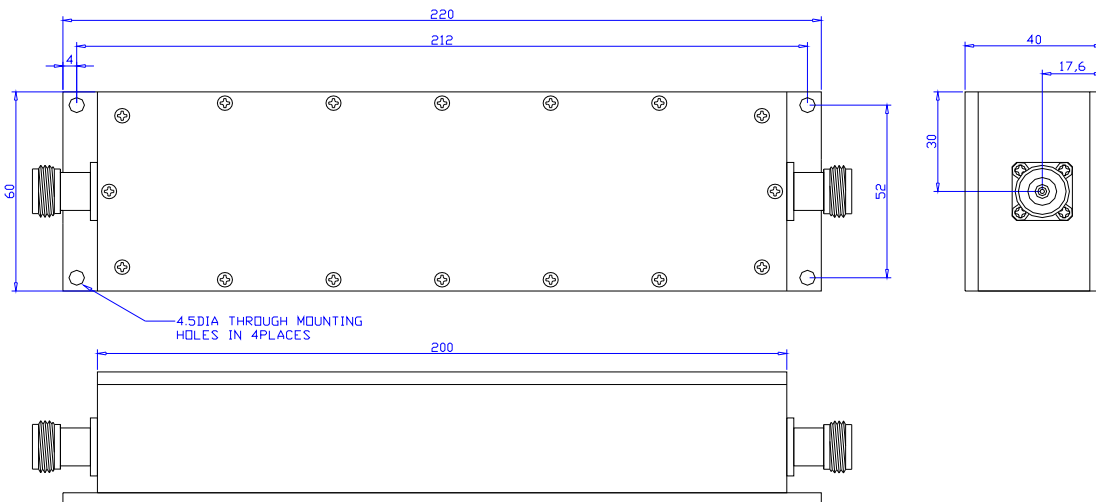

Typical Performance

